



34R-FX AC CI/D2 Inverter-Duty Gearmotors

Class I, Division 2 Construction For Hazardous Locations

Our 34R-FX AC three-phase gearmotors are now available with a factory-installed terminal box and terminal block. These gearmotors meet NEC Class I, Division 2 standards for use in environments where flammable gases or vapors may accidentally be spilled or leak into the operating area. The dual voltage, 230/460VAC rated winding makes these gearmotors compatible with many AC inverter drives (VFDs).

Class I, Division 2 Construction

- Suitable for environments where flammable vapors may occasionally be present
- Large terminal box with terminal block for easy wiring
- Fixed-speed, PSC, 115 VAC models also available from stock

FX Gearhead Features

- All steel helical gears; lubricated for life
- Gearing meets or exceeds AGMA 9 standards for quiet operation
- Synthetic lubricant improves performance, and allows these gearmotors to operate in a wide temperature range



Typical Applications

These gearmotors are designed to drive variable-speed applications such as conveyor systems, packaging equipment, metering devices, commercial appliances and applications that require Class I, Division 2 standards.

Type 34R4-FX, AC Variable Speed, Inverter-Duty Gearmotors (Groups A ,B, C and D; Temperature Code T3C)

Fixed Speed Rating					Variable Speed (SOA Ratings ¹)							Product Type	Model Number
Speed (rpm)	Torque (lb-in)	Power (HP)	Rated Current (Amps)	Gear Ratio	Speed Range (rpm)	Frequency Range (Hz)	Torque Type	Torque (lb-in)					
								@10 Hz	@60 Hz	@90 Hz			
230/460 VAC, Three-Phase, Non-Synchronous, TENV, IP-44													
5.7	350	1/6	1.0 / 0.53	300	0.4-7.3	10-90	Constant	350	350	350	34R4BFPP-FX4	3259	
9.4	350	1/6	1.0 / 0.53	180	0.7-12	10-90	Constant	350	350	350	34R4BFPP-FX4	3258	
14	350	1/6	1.0 / 0.53	120	1.0-18	10-90	Constant	350	350	350	34R4BFPP-FX4	3257	
28	321	1/6	1.0 / 0.53	60	2.0-36	10-90	Variable	257	350	350	34R4BFPP-FX3	3256	
43	214	1/6	1.0 / 0.53	40	3.0-55	10-90	Variable	171	265	265	34R4BFPP-FX3	3255	
57	160	1/6	1.0 / 0.53	30	4.0-73	10-90	Variable	128	255	221	34R4BFPP-FX3	3254	
85	107	1/6	1.0 / 0.53	20	6.0-110	10-90	Variable	86	170	147	34R4BFPP-FX3	3253	
113	80	1/6	1.0 / 0.53	15	8.0-145	10-90	Variable	64	127	111	34R4BFPP-FX2	3252	
170	53	1/6	1.0 / 0.53	10	12-218	10-90	Variable	43	85	74	34R4BFPP-FX2	3251	
340	28	1/6	1.0 / 0.53	5	24-436	10-90	Variable	22	44	38	34R4BFPP-FX1	3250	

1. SOA: Contact the factory for detailed safe operating area (SOA) performance data.
These gearmotors are supplied with a factory-installed large terminal box and terminal block.



34R-FX Class I, Division 2 Inverter-duty AC Variable-Speed Gearmotors

Dimensions (inches).

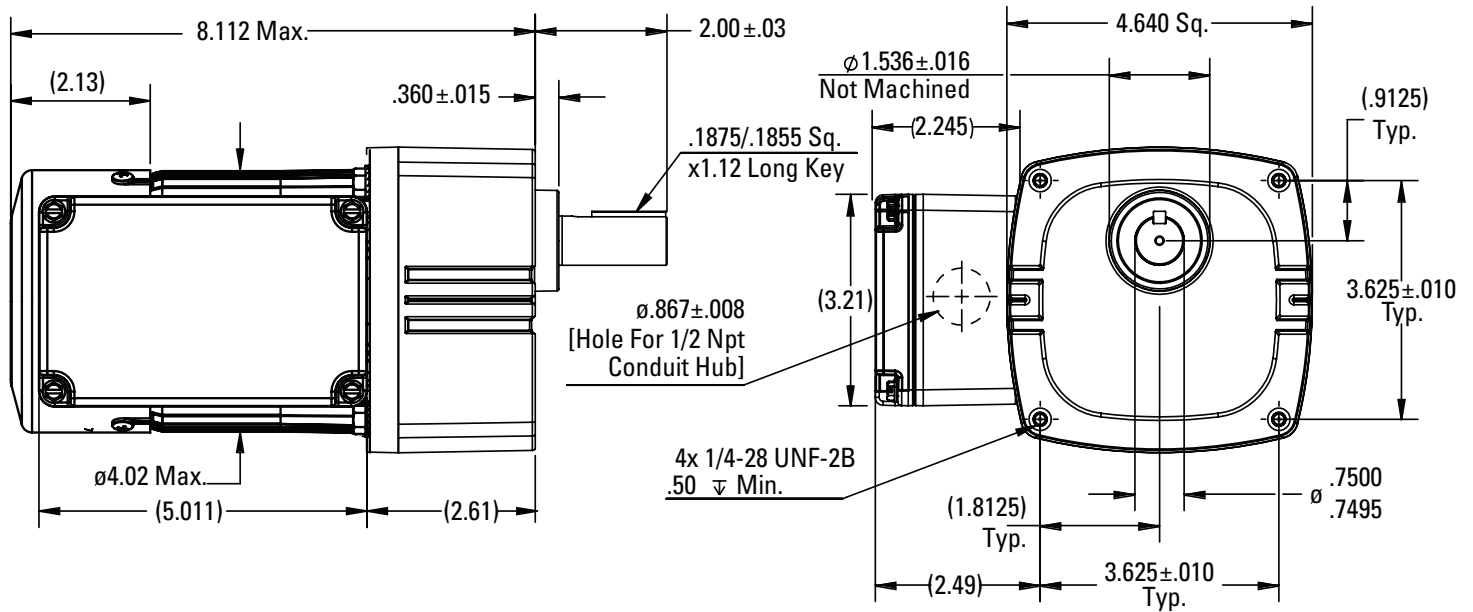

Optional Accessories



L-Bracket Kit for E, F and FX gearmotors [model 0969]

This L-bracket kit allows for base or side-wall mount of our type E, F, and FX gearmotors (will not fit 48R-F or 48R-FX). Our standard gearmotors are designed to operate in any horizontal mounting orientation (drive shaft in 12, 3, 6 or 9 o'clock position).



Adaptor plate kit for E, F, W, WX and FX gearmotors [model 0995]

This 3-hole mounting adaptor plate for our E/F, WX and FX gearmotors provides an easy way to replace various competitor gearmotors (e.g. Bison, Leeson, Grainger).

Also available as:



Brushless DC Gearmotors for Class I/Div. 2 Hazardous Locations

Type 34B/SR-WX BLDC Gearmotors with Built-In Speed Controls

Our 34B4/SR-WX INTEGRAMotors™ meet NEC Class I, Division 2 standards for use in environments where flammable gases or vapors may accidentally be spilled or leak into the operating area. Available as standard products, they combine a PWM speed control, a brushless DC motor and a high-torque gearhead in one compact package.