

Contact Us:

Tel: 1-800-7BODINE (U.S. only)

Tel: 773-478-3515

E-mail: info@bodine-electric.comCorporate Web: www.bodine-electric.com

INSTALLATION INSTRUCTIONS 07401168

Model 0934 Shaft Kit

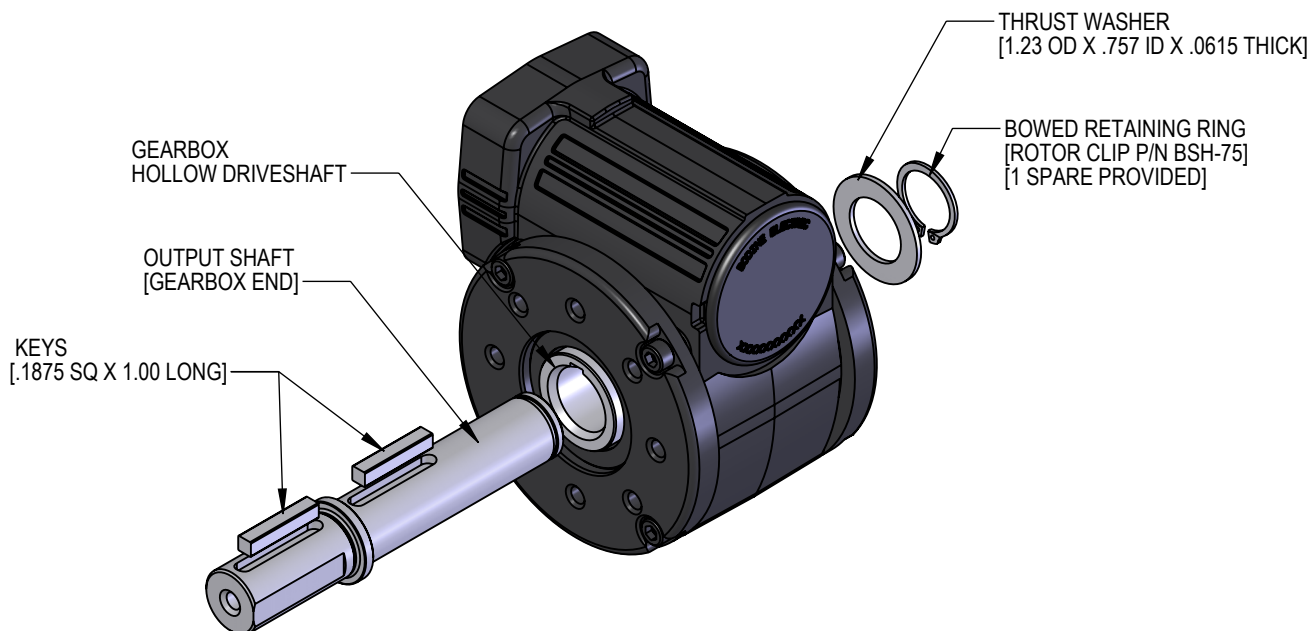

1. Insert key into keyway on gearbox end of output shaft.
2. Align key to keyway and insert the output shaft into the gearbox hollow driveshaft.
3. With output shaft shoulder flush to end of hollow driveshaft, install thrust washer and secure bowed retaining ring* in groove as shown in Detail A below. (Tip: You can use a 3/4 socket to help push retaining ring securely into groove if using the installation pliers is not successful to fully seat the retaining ring)

*RECOMMENDED INSTALLATION PLIERS FOR RETAINING RING: ROTOR CLIP RP-200, GRAINGER #3R319, MCMaster #5415A62

