



# Low-Voltage 12 VDC Type 33A7-WX PMDC Gearmotors

Now available with 2500 rpm winding and IP-55 environmental protection rating

The WX is a compact high-torque gearhead, built to provide longer life and higher performance than similar gearmotors in the same size range. These gearmotors are ideal for battery or solar-powered applications in remote locations, such as chemical pumps or access gates, and for other portable or mobile battery powered equipment.

### WX Gearhead Features

- Rated IP-55. Protected from limited dust ingress and low pressure water jets
- All steel helical gears; lubricated for life
- Gearing meets or exceeds AGMA 9 standards for quiet operation
- Synthetic lubricant improves performance, and allows these gearmotors to operate in a wide temperature range
- Adaptor plate, model 0995, allows for 3-hole mounting configuration

### 33A Permanent Magnet DC Motor

- Cartridge style brushes for easier routine brush maintenance
- Ideal for fixed and variable speed applications
- High starting torque, linear speed torque characteristics
- Heavy gauge steel housing, copper graphite brushes
- Resin-impregnated winding to provide reliable performance
- Unique skewed armature design minimizes cogging; dynamically balanced



Type 33A-WX  
with cartridge  
style brushes



### Typical Applications

Type 33A-WX gearmotors are designed to drive battery or solar-powered applications in remote locations, such as chemical pumps or access gates, and for other portable or mobile battery powered equipment.

### Parallel Shaft PMDC Gearmotor with Cartridge Style Brushes

Speed (rpm)	Rated Torque (lb-in.)	Rated Current (Amps)	Gear Ratio	Power (HP)	Form Factor	Peak Torque (lb-in.)	Radial Load (lbs.)	Product Type¹	Item Number
12 VDC, Totally Enclosed, Non-ventilated, Class F Insulation									
26	185	14	98:1	1/6	1.0	263	300	33A7BEPM-WX4	1229
38	190	14	66:1	1/6	1.0	251	290	33A7BEPM-WX3	1228
57	142	14	44:1	1/6	1.0	222	262	33A7BEPM-WX3	1226
123	70	14	20:1	1/6	1.0	221	234	33A7BEPM-WX2	1225
266	29	14	9:1	1/6	1.0	124	199	33A7BEPM-WX2	1224
455	17	14	6:1	1/6	1.0	72	173	33A7BEPM-WX2	1223



## 33A7-WX Permanent Magnet DC Gearmotor (12 VDC)

Dimensions (inches)

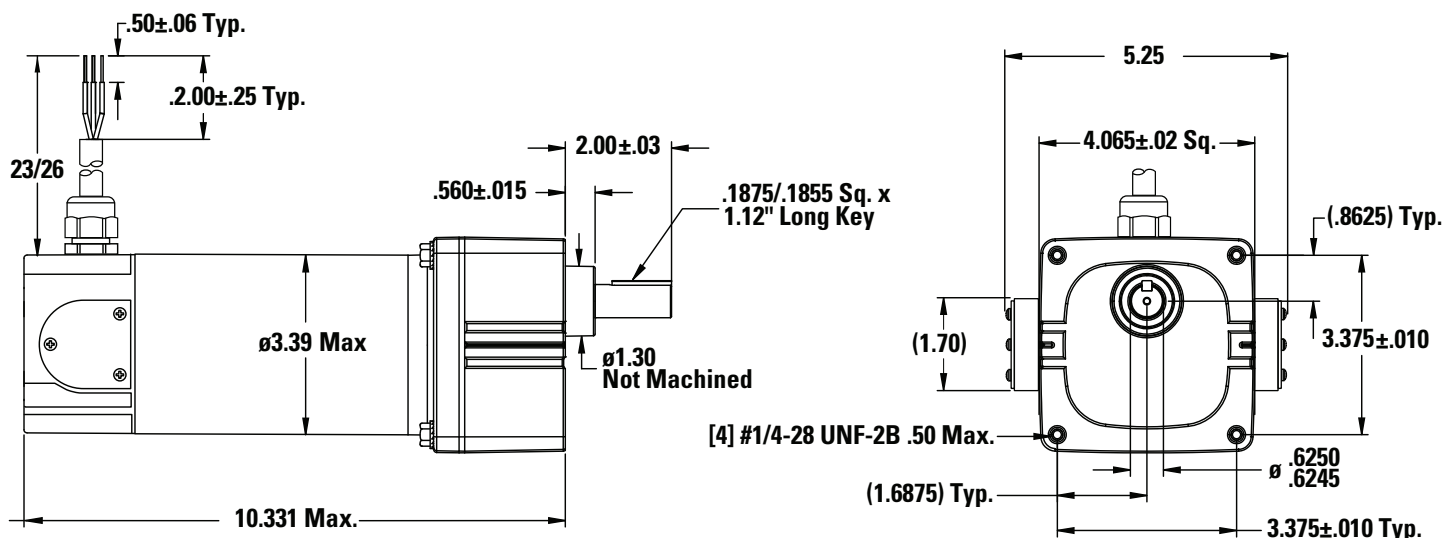

## Accessories

L-bracket model 0970



Three-hole mounting adaptor plate kit model 0995



The WX gearhead can easily be converted to be a drop-in replacement for applications that are configured with a three-hole mounting pattern.

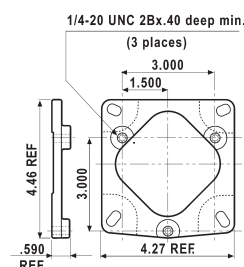

## Low-Voltage System Matched DC Speed Controls

**Buy a Bodine gearmotor and speed control as a set and get our Extended 2-Year System Warranty**

Bodine DC speed controls are designed to deliver optimal performance from our PMDC motors and gearmotors. The controls operate from 12 Volt DC. Models are available with either filtered or unfiltered DC output. Current limit, torque limit, maximum/minimum speed, and acceleration/deceleration can all be adjusted to fit your application. Chassis models feature either ¼ inch quick connect tabs or terminal block connections.

**For more information, visit [www.bodine-electric.com](http://www.bodine-electric.com)**

Chassis Speed Controls  
WPM Model 0786 and 0787

