

INSTALLATION INSTRUCTIONS 07401149

Model 0952 & 0953 Shaft Cover Kit

COVER 0952 FOR 25H2 GEARBOX

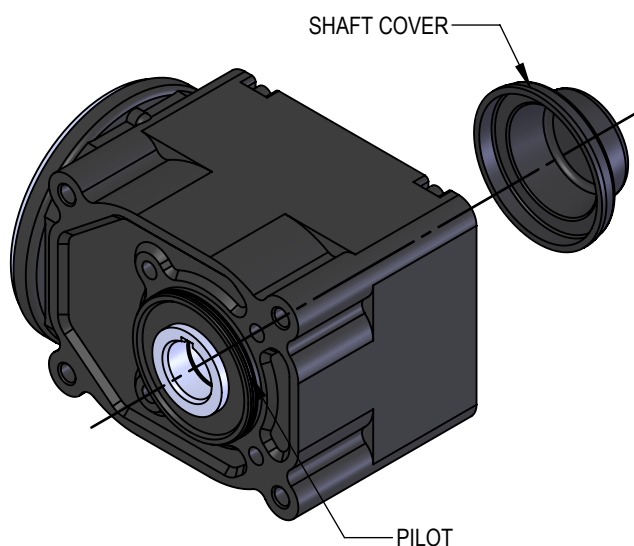

COVER 0953 FOR 30H3 GEARBOX

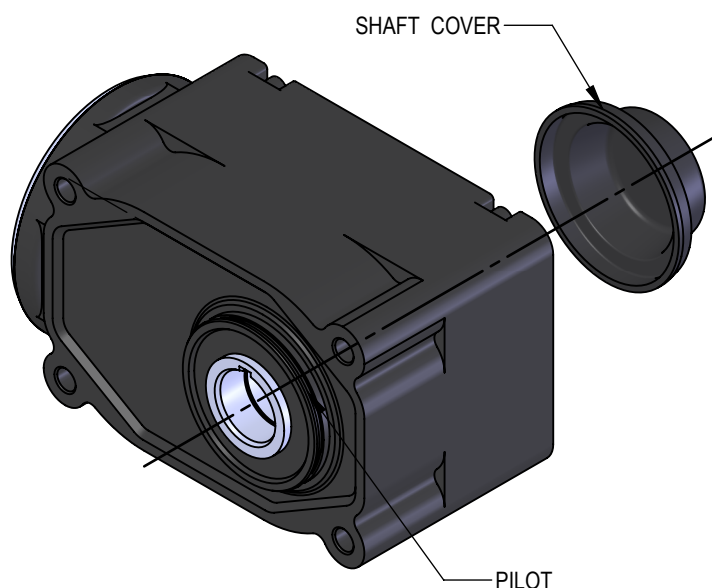

1. Center shaft cover with pilot on either side of gearbox.
2. Push the shaft cover until it snaps firmly onto the pilot.
3. Shaft cover can be installed on either side of gearbox

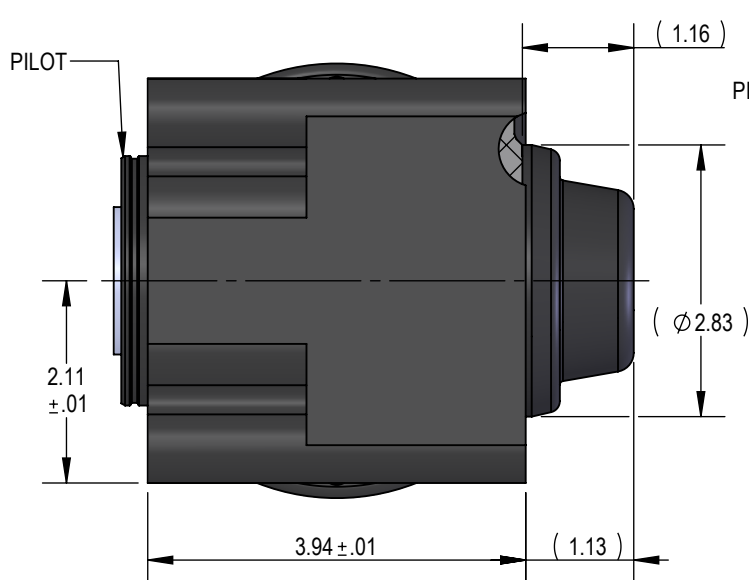

SHAFT COVER INSTALLED ON 25H2 GEARBOX

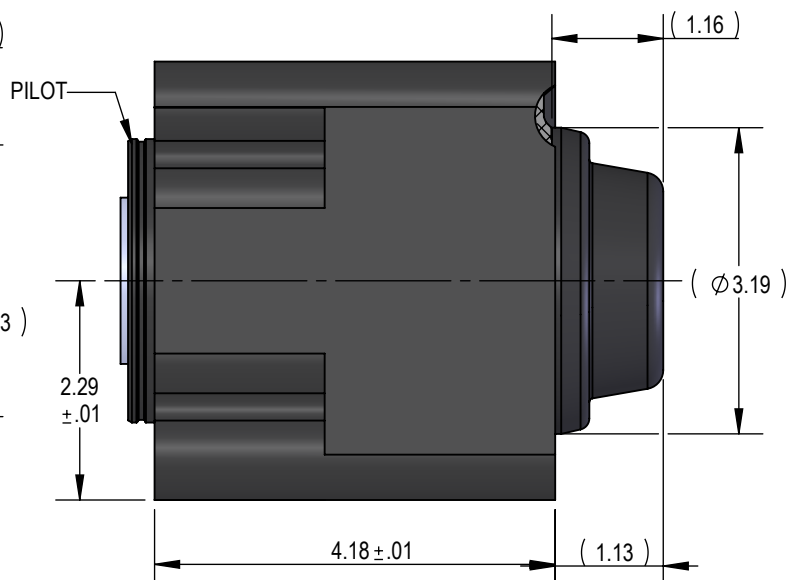

SHAFT COVER INSTALLED ON 30H3 GEARBOX