

Installation Instructions for Optional L-Bracket Kit Model 0979 for type 34R and 34B Motors (U.S./inch models only)

Included Items

Four screws and four lockwashers are included to mount the motor to the L-bracket. The holes in the base of the bracket are .281 inch diameter. They accommodate .250-inch diameter fasteners (supplied by the user) to secure the bracket to the mounting surface.

The screws should be tightened to approximately 60 in-lb. torque.

Mounting Instructions

The four holes on the largest bolt circle on the mounting face of the L-bracket are for type 34R (AC) and 34B (BLDC) motor mounting. The L-bracket can be attached to these motors for mounting in any position. If the motor is mounted with the lead exit facing the mounting surface there may not be adequate clearance for the cord, bushing or T-box between the motor and the mounting surface.

To minimize L-bracket deflection, the maximum permissible overhung load is 50 lbs (pounds force) or 220 N.

Model 0979 L-Bracket Installed. Shown with type 34R Motor (dimensions in inches unless otherwise noted)

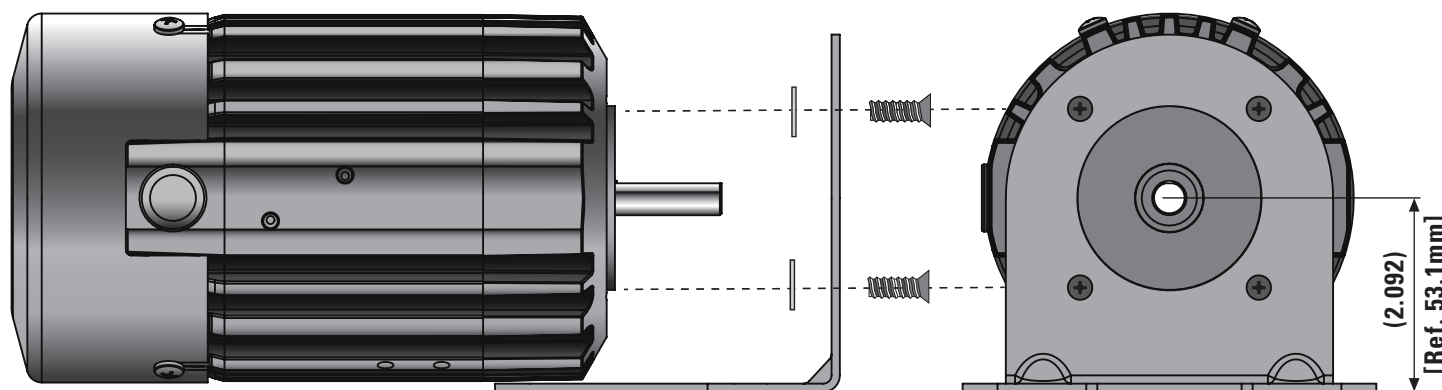

Model 0979 L-Bracket Dimensions (inches)

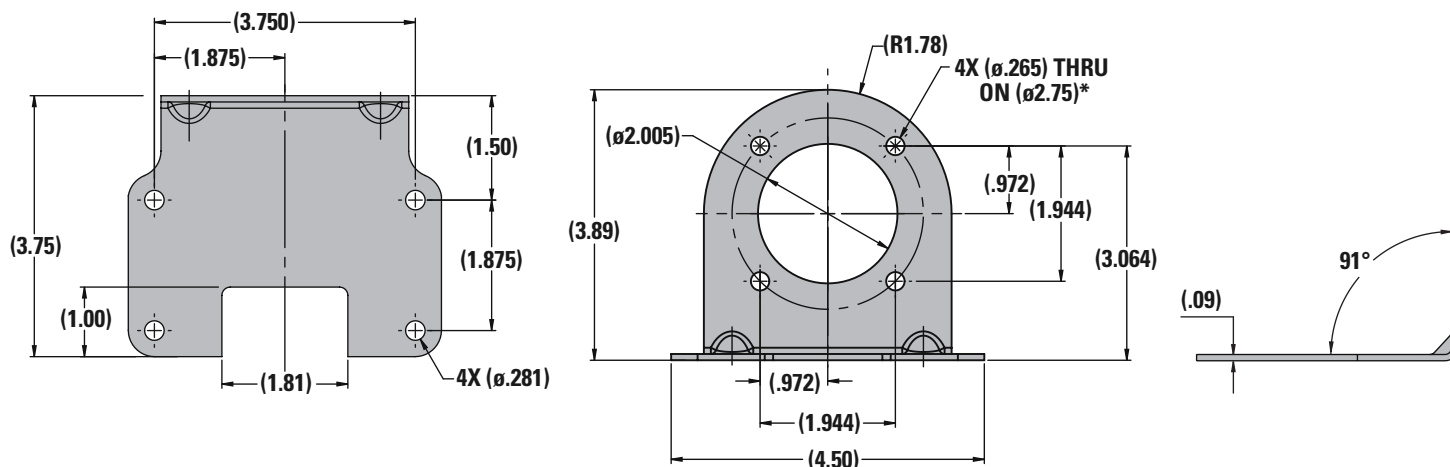

*This L-bracket cannot be used with metric 34R/34B motors (bolt circle dimensions differ).